

# 3800 COASTAL RESEARCH PATROL VESSEL

## Specifications

- Length overall: 12.20 metres
- Measured length: 11.40 metres
- Waterline length: 9.83 metres
- Beam amidships: 3.84 metres
- Draft: 1.00 metres
- Displacement (loaded): 11.5 tonnes
- Fuel capacity: 1350 litres
- Water tank capacity: 200 litres
- Engine HP: 2 x 380 HP
- Engine Make/Model: Yahmar 6LY3-UTP
- Max Speed (loaded): 28 knots

- Trolling speed 2-4 knots
- Cruising speed 18-22 knots
- AC power electric/hydraulic winch with the real time data transfer
- Davco hydraulic "A" frame gantry
- Sea water sampling underway flow through system
- Differential GPS and weather station
- Geoswath sounder in cockpit
- RDI ADCP (Acoustic Doppler Current Profiler) 300 khz 600 khz units interchangeable
- Seabird 911 CTD system with sampling rosette

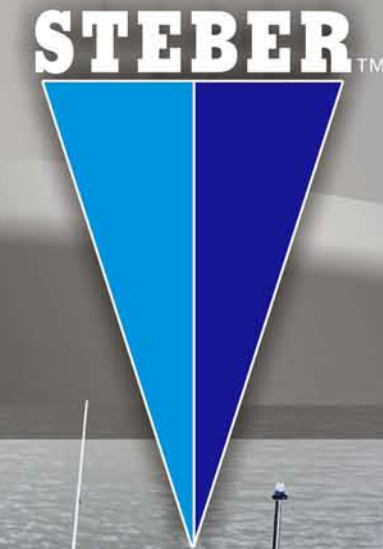
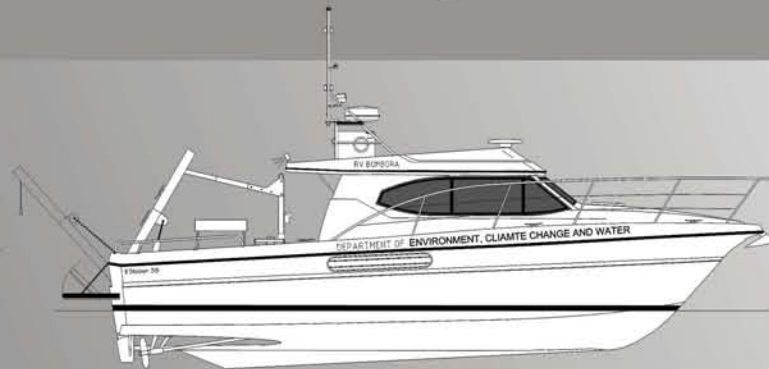
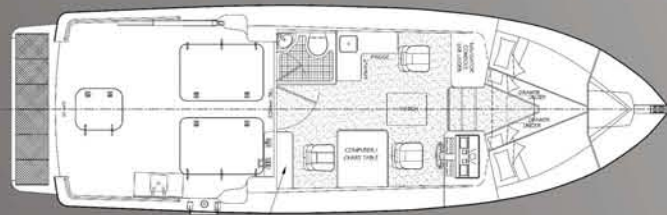

# 3800 COASTAL RESEARCH PATROL VESSEL



FOR SUPERIOR QUALITY AND CUSTOMISATION, ALWAYS ASK FOR A STEBER.



STEBER™



3800 COASTAL RESEARCH  
PATROL VESSEL